



arlo™

Solar Panel
Quick Start Guide



Welcome

Thank you for choosing the Arlo Solar Panel.

Getting started is easy.

What's Included

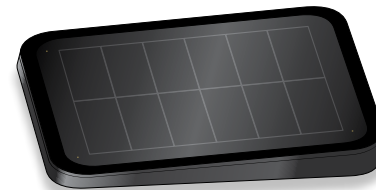

Solar panel



Mount



Screws (3)

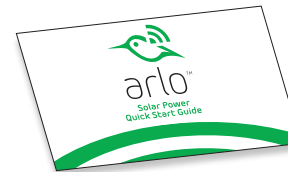

Quick Start Guide



Power cable

Position Your Arlo Solar Panel

The amount of energy that the solar panel can produce is affected by how much sunlight the solar panel receives, weather conditions, and dust or debris. A solar panel in the same location might produce a different amount of energy at noon in December than at noon in June.

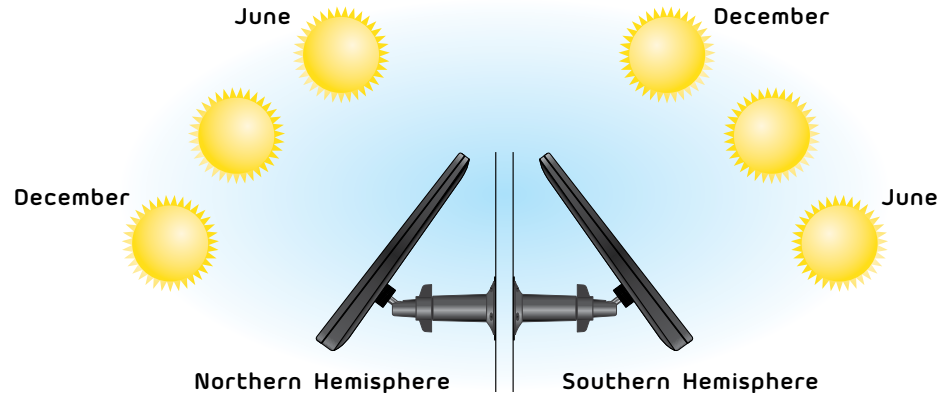

Similarly, the same panel might produce more energy in one geographic location and less in another. In both situations, the difference is based mainly on the amount of sunlight that the solar panel receives.

To optimize the effectiveness of your solar panel, do the following:

- Choose a location for your solar panel that gets the most sunlight throughout the year.
- Wipe the panel every few months to remove dust or debris that might affect the solar energy harvesting efficiency of the panel.

Install Your Solar Panel

1. Place the mount near your Arlo Pro or Arlo Go camera.
2. Secure the mount with the screws provided in the package.

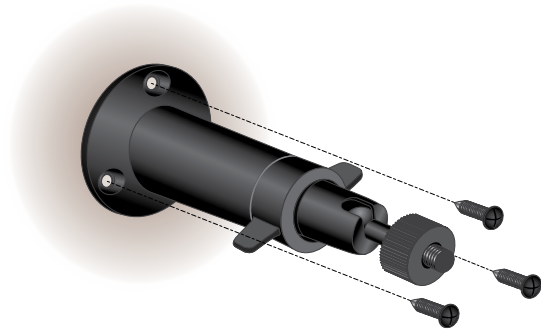

3. Attach your solar panel to the mount.
4. Adjust the angle of the solar panel on the mount to receive maximum sunlight.

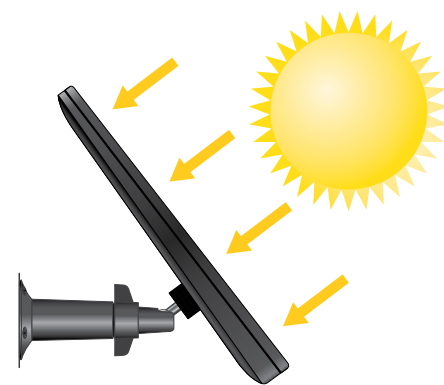
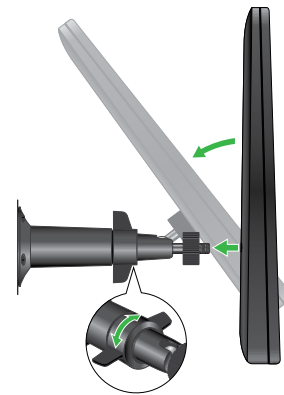
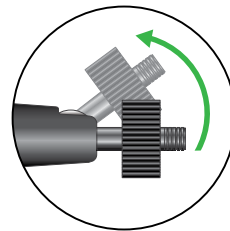

Connect Your Solar Panel to Your Camera

1. Align the power cable end with the clips on the solar panel back.
2. Pinch the clip on the connector and insert the cable end into the port on the solar panel.

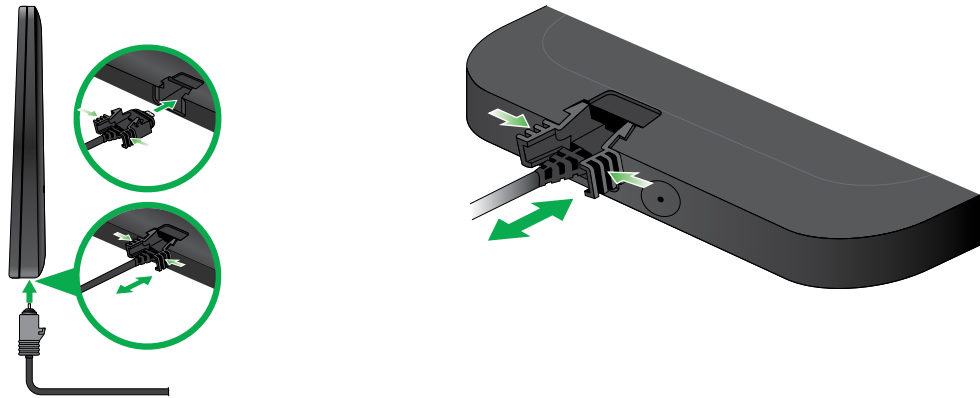

3. Connect the other end of the cable to your Arlo camera.



You're Done!

Congratulations! Your Arlo system is set up and ready to go.

To view useful tutorial videos, find troubleshooting tips, or get support, visit <https://www.arlo.com/support/>.

©NETGEAR, Inc., NETGEAR, the NETGEAR Logo, and Arlo are trademarks of NETGEAR, Inc. Any non-NETGEAR trademarks are used for reference purposes only.

Si ce produit est vendu au Canada, vous pouvez accéder à ce document en français canadien à arlo.com/docs.

(If this product is sold in Canada, you can access this document in Canadian French at arlo.com/docs.)

For the current EU Declaration of Conformity, visit <http://kb.netgear.com/11621>.

For regulatory compliance information, visit <http://www.netgear.com/about/regulatory/>.

NETGEAR®

350 East Plumeria Drive
San Jose, CA 95134, USA



NETGEAR INTL LTD

Building 3, University Technology Center
Curraheen Road, Cork, Ireland



201-21674-02

August 2017